

ATOLLO

Continuous motion dosing and capping monobloc for powder and granulated products

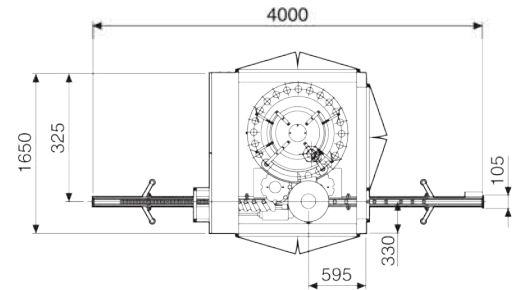
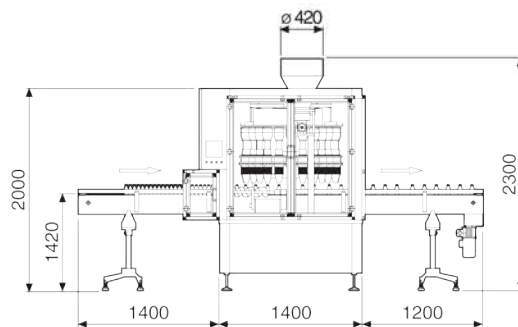
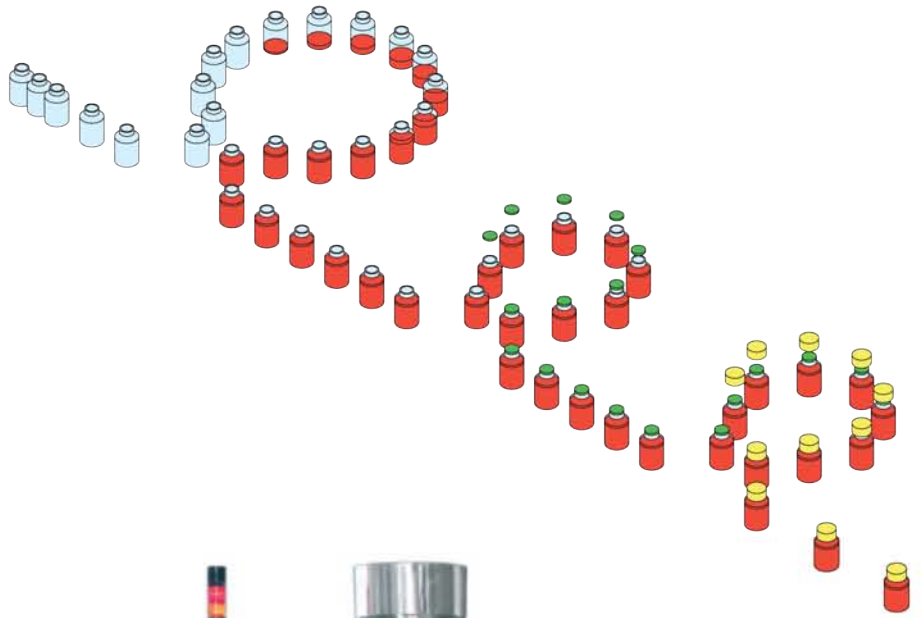

| | | |
|-----------------------------|----------------|------|
| Mechanical speed per minute | STROKES | 300 |
| Power Absorption | KW | 4 |
| Air Consumption | NI/1' | 300 |
| Air Pressure | bar | 6 |
| Gross Weight | Kg. | 2500 |

| Size range | Doses ml | A | B | C | d | e |
|------------|----------|------|-----|-----|-----|----|
| | | min. | 10 | 20 | 20 | 50 |
| max. | 1200 | 105 | 105 | 200 | 105 | 35 |

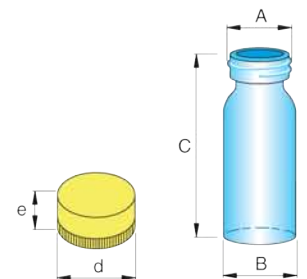

The above technical data is not binding and may be subject to change without prior notice.



CAMPAK France

**81, rue Pasteur
77462 St-Thibault des Vignes
Tel:01 60 31 54 68
Fax: 01 60 31 54 69
e-mail: campak@campak.fr**

<http://www.campak.fr>



**Machines
Catalogue**